

### GENERAL FEATURES

<b>Applications</b>	Grazer or Direct View Lighting
<b>Lens</b>	Clear, 50% Semi-Frosted, or 100% Frosted
<b>Optics &amp; Asymmetric</b>	15°, 30°, 45°, 60°, 120°, or Asymmetric Optics
<b>Length</b>	Built to Order (+/-1/8" Tolerance)
<b>Construction</b>	Aluminum Extrusion
<b>Field Cutting</b>	Dry and Damp Location Field Cuttable
<b>Weight</b>	0.47 lbs per foot
<b>Mounting</b>	Mud-In
<b>Listing</b>	Dry or Damp Location UL1598, CSA C22.2#250.0 UL8750, CSA250 UL2108, 67.1.9, 60.4, CSA C22.2 #9
<b>Driver</b>	Remote (Sold Separately)
<b>Temperature Ratings</b>	Operating / Startup: -20° to 48°C (-4° to 120°F) Storage: -40° to 76°C (-40° to 170°F)
<b>Installation Link</b>	

### END VIEWS / DIMENSIONS

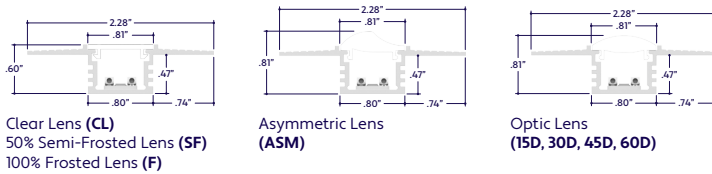

### MOUNTING OPTION

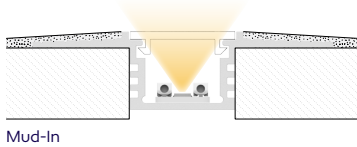

### ELECTRICAL

<b>Dimming</b>	DMX
<b>Maximum Run (Class 2 Applications)</b>	29' (2.9W), 18' (4.5W), 15' (5.5W)
<b>Luminaire Voltage</b>	24VDC

### SPECIFY PRODUCT CODE | CHOOSE FROM DROP DOWNS

Series	LED	Lens / Optics	Watts per Foot	Dimming	Listing	Finish	Luminaire Length
<b>A2-ZUVU-FLD</b>				<b>DMX</b>		<b>WH</b>	
ZUVU Flush Direct (A2-ZUVU-FLD)	Color Changing: Red, Green, Blue, 3000K White (RGBW)	Clear Lens (CL)	2.9 Watts (2.9W) 226 Lumens / ft <sup>a1</sup>	DMX-512 <sup>a2</sup> (DMX)	Indoor (DRY)	White (WH)	Specify Length in Feet & Inches Example: 7'8"
		50% Semi-Frosted Lens (SF)	4.5 Watts (4.5W) 351 Lumens / ft <sup>a1</sup>		Outdoor (DAMP)		
	Color Changing: Red, Green, Blue, 6000K White (RGBCW)	100% Frosted Lens: Line of Light (F)	5.5 Watts (5.5W) 429 Lumens / ft <sup>a1</sup>				
		Asymmetric Lens (ASM)					
		15° Optics (15D)					
		30° Optics (30D)					
		45° Optics (45D)					
		60° Optics (60D)					

**Note:** Remote drivers wattage sized based on length of run. **Example:** 10' run x 3 watts per foot = 30 watts. Driver will be sized to 30 watts maximum.

- <sup>a1</sup> Lumens per Foot based on White LED only. **Example:** 78 Lumens x 2.9 Watts = 226 Lumens per Foot.
- <sup>a2</sup> Default DMX address of each fixture is 001. Consult third party DMX commissioner to modify at time of installation.



## A2 Series | Recessed ZUVU Flush Direct RGBW (A2-ZUVU-FLD-RGBW)

TYPE

### LAMP FEATURES

**Lamp Type** Color Changing 4-Chip LEDs

**CRI**  
(Based on White Only) > 84

**Efficacy**  
(Based on White Only) 78 Lumens per Watt

### LENS / OPTICS APPEARANCE



50% Semi-Frosted Lens (**SF**)  
Slight Diode Image  
12.5% Loss Factor



Asymmetric Lens (**ASM**)  
Slight Diode Image  
18% Loss Factor



100% Frosted Lens (**F**)  
No Diode Image: Line of Light  
25% Loss Factor



Optic Lens (**15D, 30D, 45D, 60D**)  
Slight Diode Image  
18% Loss Factor

### LAMP SPECIFICATIONS

Lamp Number	Description	L70 LED Life
<b>RGBW</b>	Color Changing: Red, Green, Blue, 3000K White	40,000 hrs.
<b>RGBCW</b>	Color Changing: Red, Green, Blue, 6000K White	

### BEAM ANGLES

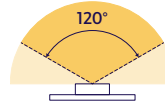

120° x 120° Beam  
Clear Lens (**CL**)  
50% Semi-Frosted Lens (**SF**)  
100% Frosted Lens (**F**)

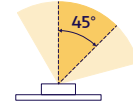

45° x 60° Beam  
Asymmetric Lens  
(**ASM**)

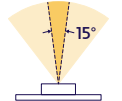

15° x 60° Beam  
Optic Lens  
(**15D**)

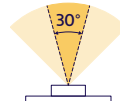

30° x 60° Beam  
Optic Lens  
(**30D**)

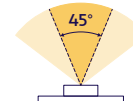

45° x 60° Beam  
Optic Lens  
(**45D**)

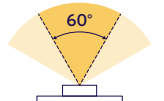

60° x 60° Beam  
Optic Lens  
(**60D**)

### DRIVERS

Dimming Selection	Product Code	Link to Specification Sheet / URL
DMX-512	(DMX)	

1170 N Red Gum St, Anaheim, CA 92806

[aluz.lighting](mailto:info@aluz.lighting) [info@aluz.lighting](mailto:info@aluz.lighting) [866.ALUZ.LTG](tel:866.ALUZ.LTG) | 714.535.7900

© ALUZ All Rights Reserved. ALUZ reserves the right to make changes or withdraw specifications without prior notice.

Specification Submittal

Page 2 of 4

9 / 28 / 2023 / Rev 7

### MITERED CORNERS (Sold Separately)

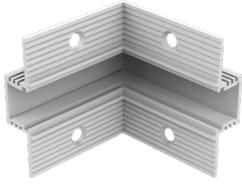

90° Internal Corner  
(A2-ZUVU-FLD-RGBW-90D-IN)

Part #	Qty.
A2-ZUVU-FLD-RGBW-90D-IN	

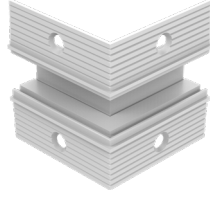

90° External Corner  
(A2-ZUVU-FLD-RGBW-90D-EX)

Part #	Qty.
A2-ZUVU-FLD-RGBW-90D-EX	

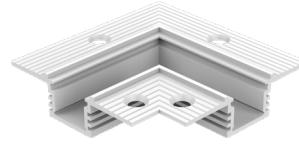

90° Linear Corner  
(A2-ZUVU-FLD-RGBW-90D)

Part #	Qty.
A2-ZUVU-FLD-RGBW-90D	

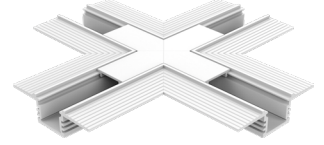

90° X Corner  
(A2-ZUVU-FLD-RGBW-90D-XC)

Part #	Qty.
A2-ZUVU-FLD-RGBW-90D-XC	

### END CAPS (Sold Separately)

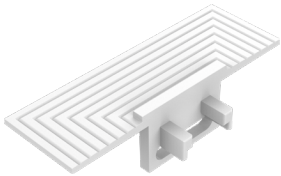

Flat End Cap for Clear, Semi-Frosted,  
or Frosted Lens  
(A2-ZUVU-FLD-EC)

Part #	Qty.
A2-ZUVU-FLD-EC	

Note: Use 1 End Cap for each termination.

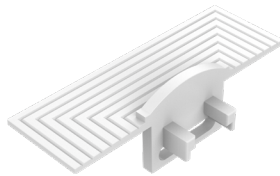

Round End Cap for Optic  
or Asymmetric Lens  
(A2-ZUVU-FLD-EC-XD)

Part #	Qty.
A2-ZUVU-FLD-EC-XD	

Note: Use 1 End Cap for each termination.

### DRY CONNECTORS (Sold Separately)

Note: Connector style subject to change without notice.  
Refer to cut sheet or installation instructions for wiring colors.

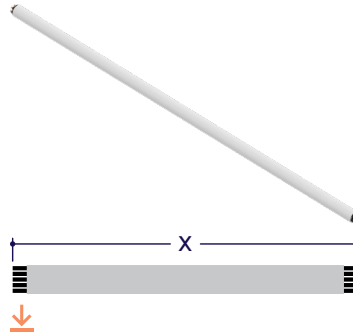

Part #	Length	Qty.
A2-PC-5P-PLM-DRY-	36"	
A2-PC-5P-PLM-DRY-		

### DMX ACCESSORIES (Sold Separately)



Part #	Qty.
DRV100-E-UNV-24VDC-DMX-DRY	
DRV100-E-UNV-24VDC-DALI-DRY	

Note: Use 1 Driver / Decoder for each run up to 100 Watts.



Part #	Qty.
CTRL-DMX-RGBX	

Note: Use 1 Decoder for each run up to 96 Watts. Not required if using all-in-one driver / decoder (DRV100-E).



Part #	Qty.
CTRL-DMX-128C	

Note: Controls up to 128 DMX Channels.



Part #	Qty.
CTRL-DMX-1024C	

Note: Controls up to 1024 DMX Channels.

## DESIGN GUIDELINES

Individual Fixture

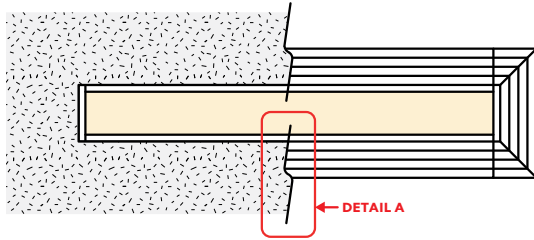
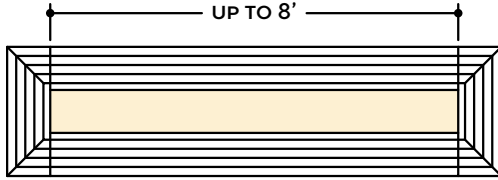

Continuous Run

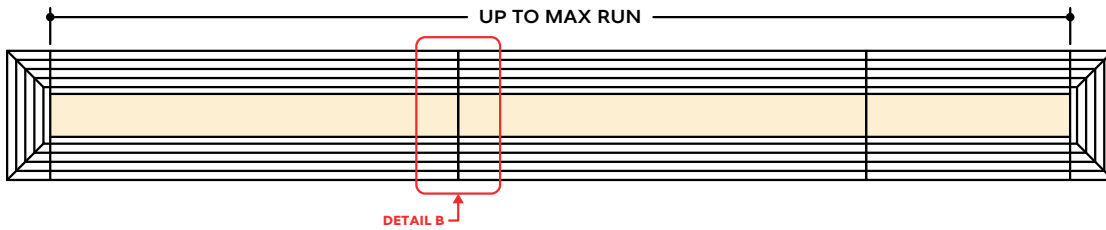

Runs with Continuous Connector

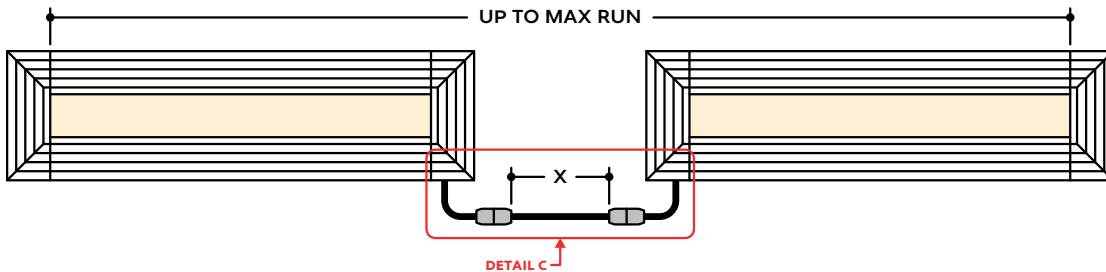

## KEY

- Detail A** **Mud-In:** Plaster is used to cover the flanges of the extrusion, leaving a flush appearance. Refer to installation instructions for details.
- Detail B** **Continuous Connection (Dry Location):** Luminaire segments connect using pins, leaving no gaps between segments. Refer to installation instructions for additional information.
- Detail C** **Dry Continuous Connector:** Used to span a corner or traverse a gap, corner, or obstacle in a dry location installation area. For Mud-In applications, the connection is located behind the mounting surface, such as drywall.

**Note:** Drawings not to scale. Product may differ from examples shown.